

InvisiClues™  
The Hint Booklet for

# PLANETFALL™



INFOCOM™

# **EMERGENCY LAST WILL AND TESTAMENT**

**Form 886513E1.2 Strictly for Use by Authorized  
CODE YELLOW Military Personnel Pursuant to  
Being Jettisoned from Exploding Third Union  
Stellar Patrol Class VII Long-Range RECON  
Space Vehicle via XB-813 Mil-Spec Quadratonic  
Escape Pod in the Event of Impending Fatal  
Disasters Consequent to**

## **PLANETFALL™**

**Keep this document in its designated XB-813  
Mil-Spec Quadratonic Escape Pod. STRICTLY  
FOR AUTHORIZED USE ONLY. Document is  
DEFINITELY NOT TO BE USED for drawing map  
of uncharted terrain following successful  
PlanETFall. Should any misuse or abuse of  
this document be perpetrated by the holder,  
said holder will have his or her or its elbows  
stapled together, and then be executed until  
dead. (See Form 886513E1.5: "Emergency  
Last Will and Testament for Use in the Event  
of Impending Fatal Disasters Consequent to  
Courtmartialing.")**

# STELLAR PATROL

## OFFICE OF MILITARY JUSTICE AND COURTMARTIALING PROCEDURES GOVT. ISSUE NO. 886513E1.2 DOC. NO. SWIZ/3950274621.U/B75

(PLEASE PRINT in purple ink and attach any and all additional documents to lower left-hand corner with Adhesium-7 Astrotape.)

Whereas, I (Stellar Patrol CODE YELLOW Officer above the Rank of Ensign 6th Class<sup>1</sup>) . . . . . ,  
(your serial number here) . . . . . , being of sound mind and body and in mortal peril, do hereby testify and avow and  
otherwise swear on my mother's head<sup>2</sup> that the Stellar Patrol is in no way responsible for my demise;

And **wherefore** I acknowledge my sole culpability for loss or damage to military property, to wit: one (1) Govt. Issue Third Union Suit<sup>3</sup>;  
one (1) SB-813 Quadratic Mil-Spec Escape Pod Model No. . . . . ; and all other possessions and appurtenances on and/or about  
my body;

**Therefore**, I the undersigned do hereby accept my debt to the Stellar Patrol<sup>4</sup>, and bequeath such portions of my personal fortune as  
remains to (here list all non-tax-exempt Third Union citizens to whom you wish to bequeath part of you estate<sup>5</sup>):

Signed this . . . . . day of . . . . . (month) in the year . . . . . T.G.U. by

I, . . . . . (sign here).

1 If holder is below rank of Ensign 6th Class, please proceed to Form 881274D2.3a: "Emergency Last Will and Testament for Use in the Event of Impending Fatal Disasters Consequent to Being Shot on Sight by a Superior for Illicit Entry of XB-813 Quadratic Mil-Spec Escape Pod Model No. . . . ."

2 If holder's mother has no head, please proceed to Form 873461H2.7j: "Emergency Last Will and Testament for Born Idiots."

3 If holder was not wearing uniform and/or 3-U suit when jettisoned, please proceed to Form 815214V9.Op: "Emergency Last Will and Testament for Use in the Event of Impending Fatal Disasters Consequent to Being Caught Dead Out of Uniform."

4 To determine the exact amount of your debt to the Stellar Patrol, take the sum value of all moneys, possessions, properties, and other valuables that make up your gross personal estate and multiply by 0.01; then subtract the dividend

from the original sum and remit that amount to the Stellar Patrol. Now subtract 55% of the remaining estate and remit it to the Third Union Will Execution and Paper Processing Tax Service. The remainder is your net fortune. (However, certain regional star cluster and local taxes may apply.)

5 Not to exceed one item per heir; nor should items exceed an individual value of 71 credits.

# ALL OTHER POSSESSIONS I HEREBY BEQUEATH TO THE STELLAR PATROL ADMIRALS' SHUFFLEBOARD TOURNAMENT FLORAL DECORATIONS FUND-RAISING COMMITTEE:

## LEGEND:

— NORMAL PASSAGEWAY  
 - - - - - PASSAGEWAY REQUIRING SPECIAL EQUIPMENT OR PROBLEM SOLVING  
 - - - - - ONE-WAY PASSAGEWAY

NOTE: I HAVE ONLY LISTED THE OBJECTS THAT CAN BE TAKEN AND THAT ARE VISIBLE WHEN I FIRST ENTERED A ROOM, WHERE MORE THAN ONE DIRECTION LEADS TO THE SAME PLACE, I ONLY SHOWED THE ONE I USED FIRST.

1  
2  
3  
4  
5  
6  
7  
8  
9  
10  
11  
12  
13  
14  
15  
16  
17  
18  
19  
20  
21  
22  
23  
24  
25  
26  
27  
28  
29  
30  
31  
32  
33  
34  
35  
36  
37  
38  
39  
40  
41  
42  
43  
44  
45  
46  
47  
48  
49  
50  
51  
52  
53  
54  
55  
56  
57  
58  
59  
60  
61  
62  
63  
64  
65  
66  
67  
68  
69  
70  
71  
72  
73  
74  
75  
76  
77  
78  
79  
80  
81  
82  
83  
84  
85  
86  
87  
88  
89  
90  
91  
92  
93  
94  
95  
96  
97  
98  
99  
100

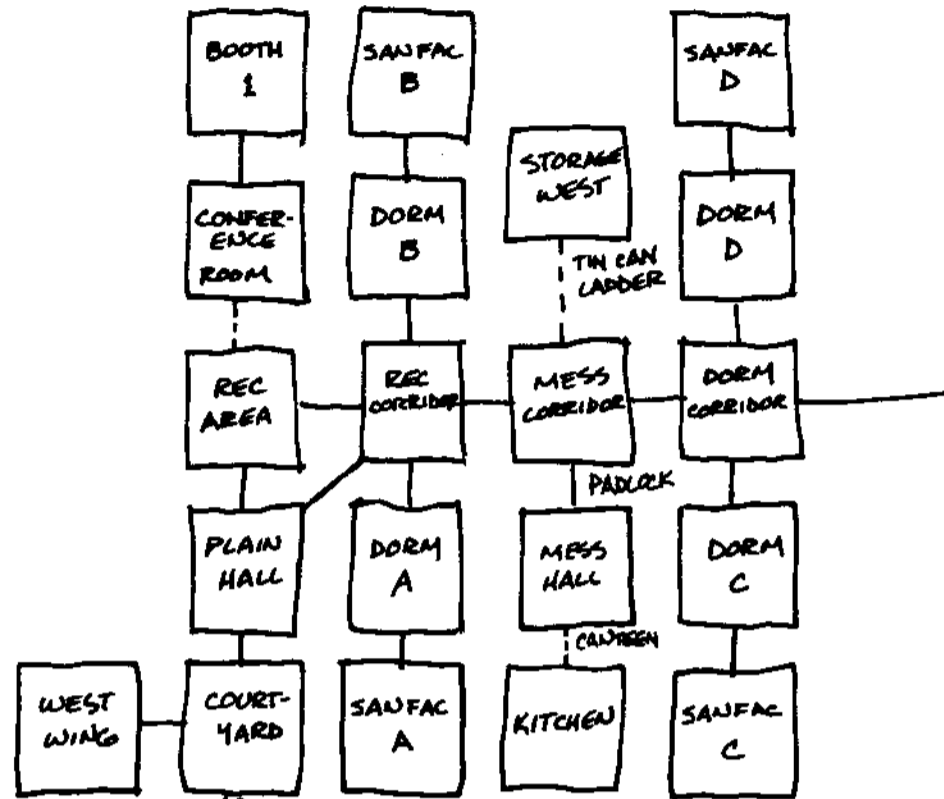

COMPLEX ONE  
(KALAMONTEE KOMPLEKS)

OUT FROM ESCAPE POD

NOTE: SHUTTLE CARS SHOWN HERE AT EASTERN END OF SHUTTLE TUBES.

OUT TO UNDERWATER

ABOARD THE S.P.S. FEINSTEIN

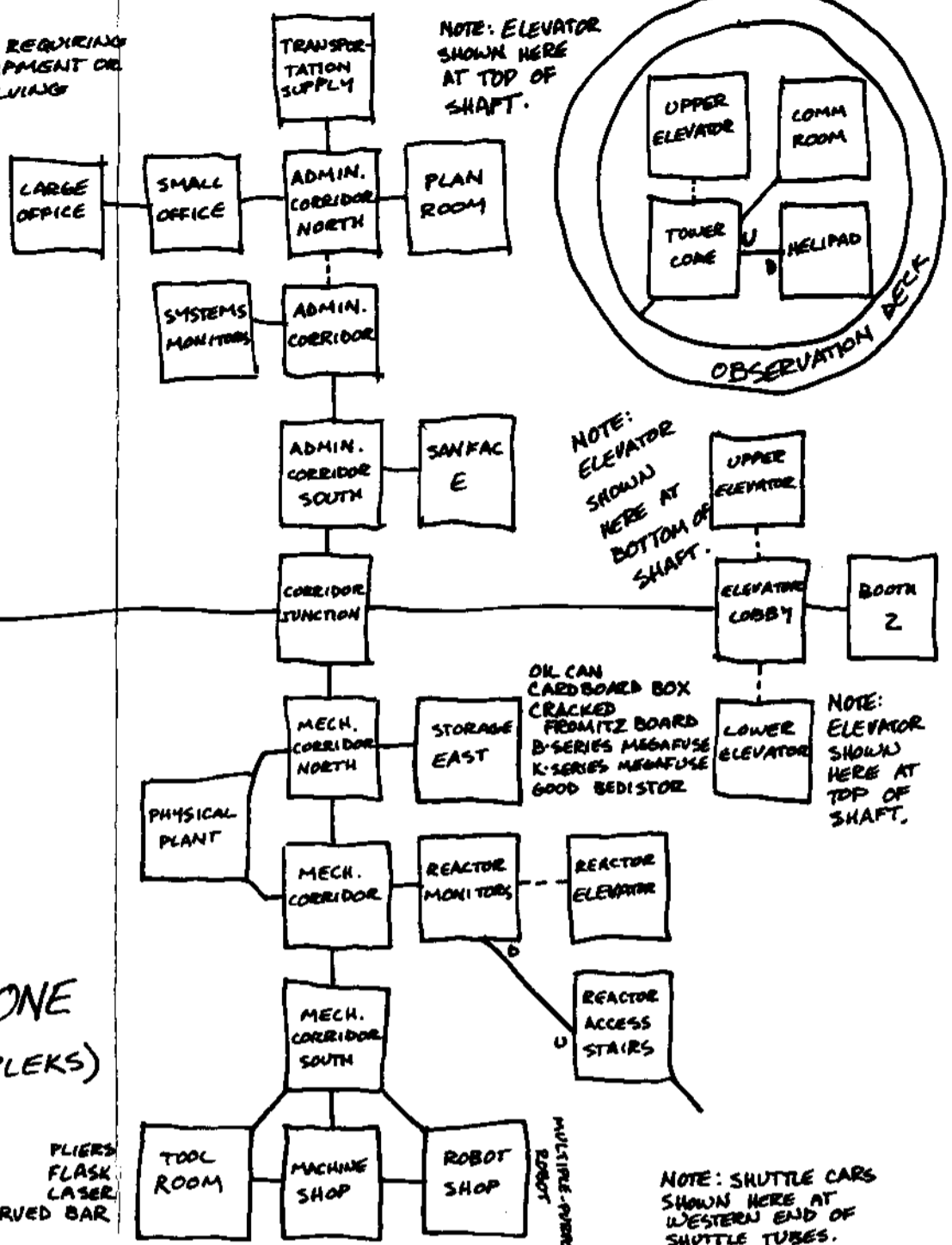

COMPLEX TWO  
(LAWANDA KOMPLEKS)

NOTE: ELEVATOR SHOWN HERE AT TOP OF SHAFT.

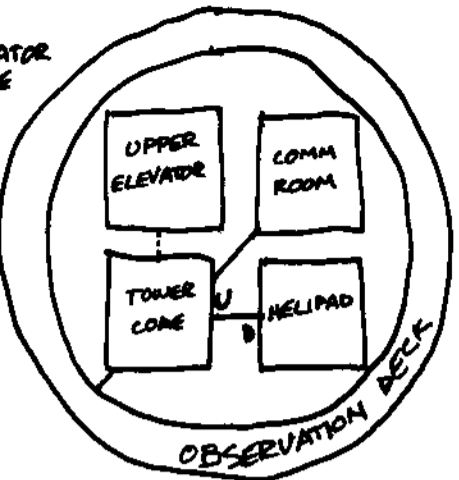

NOTE: ELEVATOR SHOWN HERE AT BOTTOM OF SHAFT.

OIL CAN  
 CARDBOARD BOX  
 CRACKED FIBROITZ BOARD  
 B-SERIES MEGAFUSE  
 K-SERIES MEGAFUSE  
 GOOD BEDISTOR

NOTE: ELEVATOR SHOWN HERE AT TOP OF SHAFT.

NOTE: SHUTTLE CARS SHOWN HERE AT WESTERN END OF SHUTTLE TUBES.

NOTE: ELEVATOR SHOWN HERE AT BOTTOM OF SHAFT.

BROWN SPOOL PORTABLE CAMP

MINIATURIZATION ACCESS CARD

TO STATION 304

FROM MINIATURIZATION BOOTH

FROM STATION 304

NOTE: ELEVATOR SHOWN HERE AT TOP OF SHAFT.